

# Judging Programs

## 13 Shows • Same Location

WEDNESDAY

RIVER CITY INDEPENDENT SPECIALTIES:  
ALAMO BRITTANY CLUB  
GERMAN SHORTHAIRED POINTER CLUB OF SAN ANTONIO  
SAN ANTONIO ENGLISH SPRINGER SPANIEL CLUB, INC.  
ALAMO AREA TOY DOG CLUB, INC.



THURSDAY



FRIDAY



SATURDAY



SUNDAY



AMERICAN  
KENNEL CLUB®

THESE SHOWS ARE  
BEING HELD UNDER  
AMERICAN KENNEL CLUB  
RULES AND REGULATIONS

Specialty Shows  
**RIVER CITY  
INDEPENDENT SPECIALTIES**

All Clubs are Licensed by the American Kennel Club

Alamo **BRITTANY** Club - 2011147001

**GERMAN SHORTHAIRED POINTER** Club of San Antonio - 2011049605

San Antonio **ENGLISH SPRINGER SPANIEL** Club, Inc. - 2011049701

Alamo Area **TOY DOG** Club, Inc. - 2011616402

**SHOW HOURS: 8:00 am to 10:00 pm**

**CONCURRENT NATIONAL SPECIALTY SHOW**

**YORKSHIRE TERRIER CLUB OF AMERICA, INC.** - 2011078003

**SHOW HOURS: 7:00 am to 5:00 pm**

**WEDNESDAY, JULY 13, 2011** - Pages 11-13

**All Breed Dog Shows**

**BEXAR COUNTY KENNEL CLUB, INC.**

Member of the American Kennel Club

[www.bexarcountykc.com](http://www.bexarcountykc.com)

**THURSDAY, JULY 14, 2011** • 2011026001 - Pages 14-16

**SUPPORTED ENTRY WITH SWEEPSTAKES**

**YORKSHIRE TERRIER CLUB OF AMERICA, INC.**

**SATURDAY, JULY 16, 2011** • 2011026002 - Pages 20-22

**REGIONAL CONCURRENT SPECIALTY SHOW**

**GERMAN SHORTHAIRED POINTER CLUB OF AMERICA** - 2011149822 - Page 13

**CONCURRENT SPECIALTY SHOWS**

**ALAMO GREAT DANE CLUB, INC.** - 2011049401 - Page 13

**ALAMO PAPILLON SOCIETY** - 2011494701 - Page 13

**DESIGNATED SPECIALTY SHOWS**

**THE BLUEBONNET NORFOLK TERRIER CLUB** - 2011676701

**LONE STAR NORWICH TERRIER CLUB** - 2011676801

**SUPPORTED ENTRY**

**SWEDISH VALLHUND CLUB OF AMERICA**

**SHOW HOURS - 8:00 am to 8:00 pm**

**PLEASE NOTE:** No officer, board member or show committee member of the Bexar County Kennel Club, Inc. shall personally exhibit a dog at this show.

**All Breed Dog Shows**

**COMAL COUNTY KENNEL CLUB, INC.**

Licensed by the American Kennel Club

**FRIDAY, JULY 15, 2011** • 2011091901 - Pages 17-19

**CONCURRENT SPECIALTY SHOW**

**DOBERMAN PINSCHER CLUB OF SAN ANTONIO** - 2011080302 - Page 13

**SUNDAY, JULY 17, 2011** • 2011091902 - Pages 23-25

**SHOW HOURS • 7:00 am to 7:00 pm**

**THE SHOW CHAIRMAN WILL NOT PERSONALLY EXHIBIT DOGS AT THIS SHOW.**

## JOE & HARRY FREEMAN COLISEUM COMPLEX

Exposition Halls A B & C  
3201 E Houston St  
San Antonio, Texas 78219  
[www.rivercitycds.com](http://www.rivercitycds.com)

**THESE SHOWS WILL BE HELD INDOORS • UNBENCHED**

### NEW EXHIBITOR BRIEFING

A new Exhibitor Briefing will be held 30 minutes prior to the published start of judging on Saturday. The briefing location will be posted at the Superintendent's table. Spectators are welcome to attend.

### SHOW VETERINARIAN (ON CALL)

PERRIN-410 ANIMAL HOSPITAL  
8365 Perrin Beitel • (210) 650-3141

HOURS: 7:00 am until 11:00 pm

**DIRECTIONS TO VETERINARIAN'S OFFICE:** Take IH-35N. Proceed to Walzem Rd exit. Left on Walzem Rd to Austin Hwy. Left on Austin Hwy, 1/2 block to right on Perrin Beitel. Hospital is approximately 1/2 mile on the left side of Perrin Beitel.

### EXHIBITOR WRIST BANDS

Wrist bands will be issued to allow easy movement throughout the building and grounds. Pick up your wrist band at the Event Service desk after 2:00 pm, Tuesday, July 12, 2011.

**Eukanuba® Dog Food is proud to be  
the exclusive pet food supporter of  
the River City Cluster of Dog Shows.**

**Eukanuba** 

Member: Dog Show Superintendents Association



American  
Kennel Club  
Annually Licensed  
Superintendents

Tiffany R Fields • Nancy E Gines • John Goosen • Michele J Goosen  
Candy E James • Christopher L James • HT (Terry) James  
Mary Beth James • Tim E James • Dorothy Lippincott • John McDonald  
Sandra McDonald • Antony M Onofrio • Jack David Onofrio • Patricia Onofrio  
Sue Onofrio • Glen Power • Jo Nell Rogers • Michael C Schmitt  
Reggie Turner • Sharon Turner • Greg S Wetmore

PO Box 25764  
Oklahoma City, Oklahoma 73125-0764  
Phone: (405) 427-8181 • [www.onofrio.com](http://www.onofrio.com)

PO Box 4660  
Portland, Oregon 97208-4660  
Phone: (503) 239-1080

# River City Cluster of Dog Shows

## July 13-17, 2011

### Exposition Hall at the Freeman

RV Parking

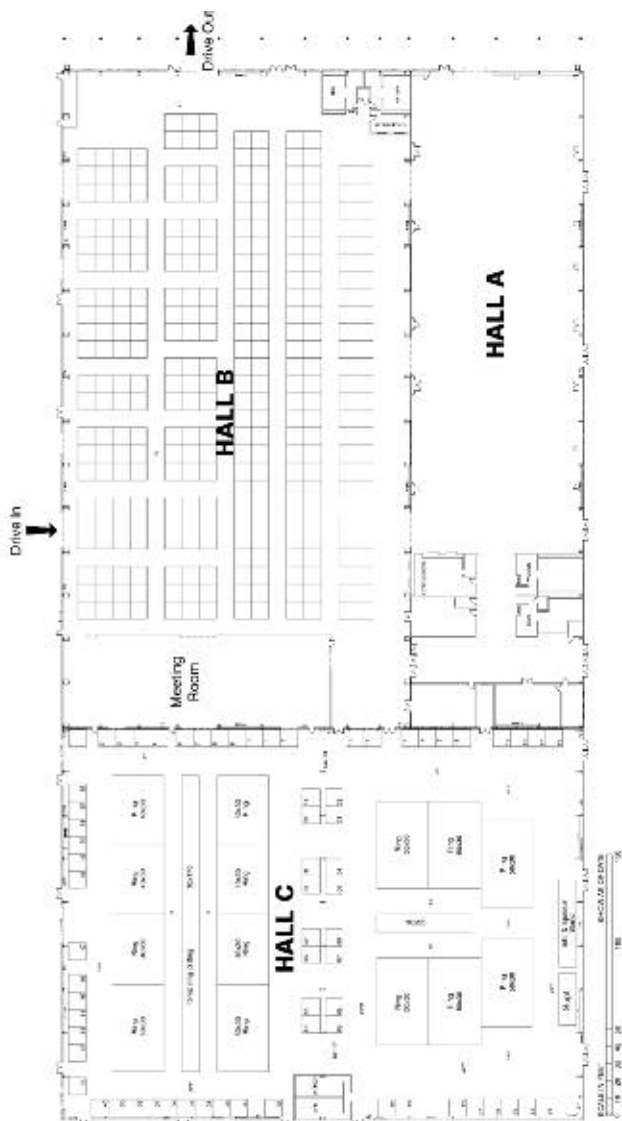

↑ ↑ ↑ ↑ ↑ Exhibitor Parking ↑ ↑ ↑

100% HIGH QUALITY

# MONA

SHE ISN'T JUST SOMEONE'S BEST FRIEND. WHEN HER OWNER IS UNDER STRESS, SHE CAN LOWER THEIR BLOOD PRESSURE BETTER THAN MAN-MADE MEDICINE ALONE.

Bring out the extraordinary in your dog.



Exclusively at  
Pet Specialty Stores

Dogs can be our most healing friends. But she can't tell you when something is wrong with her. You can help keep her in top condition with the Eukanuba Vital Health System™, with clinically proven ingredients to promote healthy digestion. Settle for nothing less than extraordinary nutrition.

The Eukanuba Vital Health System™



**Eukanuba** 

## JUDGING PROGRAM BY ALPHABETICAL ORDER

BREED	THR		FRI		SAT		SUN	
	RING	TIME	RING	TIME	RING	TIME	RING	TIME
AFFENPIN	4	12:55 pm	11	12:45 pm	4	12:35 pm	6	12:55 pm
AFGHAN	12	12:50 pm	11	1:45 pm	3	2:00 pm	9	12:50 pm
AIREDALE	8	12:55 pm	7	1:00 pm	5	1:00 pm	4	12:35 pm
AKITA	1	11:25 am	5	12:55 pm	5	1:00 pm	8	12:45 pm
ALAS MAL			4	12:55 pm	8	12:40 pm	7	11:00 am
AM FOXHND	8	11:20 am	10	10:30 am	10	2:15 pm	11	1:00 pm
AM STAFF	6	9:00 am	7	9:00 am	5	9:00 am	4	8:30 am
AMER ESK DOG	1	10:20 am	7	11:15 am	9	1:55 pm	9	2:00 pm
ANATOLIAN SHEP	8	12:55 pm	4	12:55 pm	8	9:25 am	8	9:40 am
AUST SHEP	9	10:25 am	10	12:25 pm	8	12:40 pm	2	10:05 am
AUSTR CATTDG	12	12:50 pm	1	9:00 am	1	9:00 am	2	12:50 pm
AUSTR TERR	11	10:10 am	6	12:55 pm	7	11:40 am	5	12:40 pm
BASENJI	12	9:00 am	1	10:05 am	11	10:15 am	10	11:00 am
BASSET	8	9:00 am	1	9:00 am	1	9:00 am	10	8:30 am
BEAGLE-13 IN	8	11:20 am	5	9:00 am				
BEAGLE-15 IN	8	11:20 am	5	9:00 am	10	1:00 pm	10	12:50 pm
BEARD COLL	12	12:50 pm	3	12:55 pm	9	1:55 pm	2	12:50 pm
BEAUCERON	11	12:50 pm	11	1:45 pm	5	1:00 pm	3	11:15 am
BEDLINGTON	8	12:55 pm	6	12:55 pm	5	2:00 pm	5	12:40 pm
BEL MAL	3	1:00 pm	1	11:05 am	8	12:40 pm	2	12:50 pm
BEL SHP	3	1:00 pm	1	11:05 am	8	10:40 am	2	12:50 pm
BEL TERV	3	1:00 pm	1	11:05 am	8	10:40 am	2	11:15 am
BERNS MTN	8	12:55 pm	4	12:55 pm	8	12:40 pm	7	11:00 am
BICHON	5	3:00 pm	7	1:00 pm	7	2:45 pm	9	2:00 pm
BLACK RUSS	1	11:25 am	1	11:05 am	5	1:00 pm	7	11:00 am
BORDER COLL	11	9:00 am	11	11:30 am	8	9:25 am	2	11:15 am
BORDER TERR	6	11:15 am	6	10:00 am	5	1:00 pm	5	10:40 am
BORZOI	8	11:20 am	1	11:05 am	3	2:00 pm	11	1:00 pm
BOSTON TERR	8	11:20 am	4	10:25 am	4	12:35 pm	4	10:05 am
BOUV DES FLAN	11	12:50 pm	9	2:20 pm	8	10:40 am	11	1:00 pm
BOXER	3	10:10 am	8	1:50 pm	9	10:50 am	10	8:30 am
BOYKIN	10	12:50 pm	5	12:55 pm	7	2:45 pm	1	10:45 am
BRIARD	11	12:50 pm	9	2:20 pm	8	12:40 pm	1	10:45 am
BRITTANY	9	9:00 am	9	10:20 am	12	1:00 pm	10	12:50 pm
BRUSS GRIF	4	12:55 pm	5	12:55 pm	10	11:30 am	6	9:30 am
BULL TER COLOR	11	9:00 am	6	9:00 am	5	10:25 am	5	9:40 am
BULL TER WHITE					5	10:25 am	5	9:40 am
BULLDOG	8	9:00 am	4	9:00 am	10	9:00 am	5	8:30 am
BULLMASTIFF	2	9:00 am	1	9:00 am	3	10:40 am	8	9:40 am
CAIRN TERR	11	10:10 am	4	12:55 pm	7	11:40 am	4	12:35 pm
CANE CORSO	3	10:10 am	3	11:15 am	9	10:50 am	2	11:15 am
CARD WELSH CORG	11	9:00 am	4	11:30 am	8	9:25 am	11	10:50 am
CAV KING CH	4	12:55 pm	11	10:10 am	4	2:10 pm	7	12:55 pm
CHES BAY RET	11	9:00 am	2	9:00 am	2	1:05 pm	8	9:40 am
CHIHUA LONG	4	9:00 am	6	1:50 pm	4	10:30 am	6	1:55 pm
CHIHUA SMOOTH	4	9:00 am	6	3:15 pm	4	10:30 am	6	1:55 pm
CHIN CREST	4	10:30 am	7	11:15 am	12	10:15 am	7	11:00 am
CHIN SHAR-PEI	9	10:25 am	12	12:50 pm	10	9:00 am	5	9:40 am
CHOW	8	9:00 am	6	1:50 pm	10	9:00 am	3	10:10 am
CKR SPN ASCOB	10	2:10 pm	9	12:55 pm	10	11:30 am	8	12:00 pm
CKR SPN BLACK	10	10:05 am	9	11:40 am	10	1:00 pm	8	2:20 pm
CKR SPN PARTI	10	2:10 pm	9	12:55 pm	10	1:00 pm	8	12:00 pm
CLUMBER SPN	10	10:05 am	5	12:55 pm	10	10:20 am	1	10:45 am
COLL ROUGH	11	12:50 pm	9	2:20 pm	8	12:40 pm	1	10:45 am
COLL SMOOTH	11	12:50 pm	9	2:20 pm	8	12:40 pm	1	10:45 am
DACH LONG	12	9:00 am	1	10:05 am	1	11:20 am	9	2:00 pm
DACH SMOOTH	12	9:00 am	1	11:05 am	1	11:20 am	9	2:00 pm
DACH WIRE	12	10:05 am	1	10:05 am	1	11:20 am	9	2:00 pm
DALMATIAN	8	10:10 am	6	1:50 pm	10	10:20 am	4	8:30 am
DOBERMAN	2	10:05 am	3	9:00 am	1	10:15 am	10	9:50 am

## JUDGING PROGRAM BY ALPHABETICAL ORDER

BREED	THR		FRI		SAT		SUN	
	RING	TIME	RING	TIME	RING	TIME	RING	TIME
DOGO ARGE	8	12:55 pm	3	12:55 pm	11	12:55 pm	2	12:50 pm
DOGUES DE BOR	2	10:05 am	1	9:00 am	3	12:40 pm	3	1:55 pm
ENG SETT	3	1:00 pm	12	12:50 pm	2	1:05 pm	10	11:00 am
ENG SPRINGER	8	12:55 pm	2	11:50 am	12	11:15 am	8	2:20 pm
ENGLISH COCKER	10	2:10 pm	12	12:50 pm	1	11:20 am	1	8:30 am
ENGOYSP B&PC	4	12:55 pm	7	1:00 pm	8	12:40 pm		
ENGOYSP KC&R	4	12:55 pm	7	11:15 am	8	12:40 pm	7	9:40 am
FINN LAPP	3	11:15 am	11	1:45 pm	10	2:15 pm	3	1:55 pm
FLAT COAT RET	9	10:25 am	10	10:30 am	11	10:15 am	7	11:00 am
FOX TER SMOOTH	6	11:15 am	6	10:00 am	5	2:00 pm	5	10:40 am
FOX TER WIRE	6	11:15 am	6	12:55 pm	5	1:00 pm	5	12:40 pm
FRENCH BULL	1	9:00 am	4	9:00 am	6	9:00 am	9	9:30 am
GERM PIN	2	11:15 am	1	11:05 am	3	12:40 pm	3	1:55 pm
GERM SHEPHERD	12	11:05 am	3	10:15 am	9	12:50 pm	2	8:30 am
GERM SHT PNT	3	9:00 am	9	9:00 am	11	9:00 am	8	8:30 am
GERM WIRE PNT	9	10:25 am	9	12:55 pm	11	12:55 pm	7	11:00 am
GIANT SCHN	1	11:25 am	9	2:20 pm	3	12:40 pm	8	9:40 am
GOLD RET	3	1:00 pm	2	9:00 am	11	12:55 pm	1	10:45 am
GORD SETT	3	1:00 pm	9	12:55 pm	2	1:05 pm	1	8:30 am
GREAT DANE	2	11:15 am	10	9:00 am	9	9:00 am	3	8:30 am
GREYHND	12	12:50 pm	1	9:00 am	11	10:15 am	11	8:30 am
GRT PYRENEES	1	11:25 am	1	11:05 am	3	12:40 pm	3	11:15 am
GRT SWISS MTN	2	11:15 am	1	11:05 am	3	10:40 am	3	1:55 pm
HARRIER	8	11:20 am	10	10:30 am	10	2:15 pm	11	1:00 pm
HAVANESE	4	11:40 am	7	1:00 pm	7	10:20 am	7	9:40 am
IBIZAN HND	8	11:20 am	10	10:30 am	10	2:15 pm	11	1:00 pm
ICELANDIC SHEEP					9	12:50 pm	11	1:00 pm
IRISH SETT	3	11:15 am	1	12:10 pm	2	10:25 am	2	12:05 pm
IRISH WOLFHND	8	11:20 am	10	10:30 am				
ITAL GRYHND	4	9:00 am	7	10:00 am	4	9:00 am	7	8:30 am
JAP CHIN	4	10:30 am	6	3:15 pm	4	12:35 pm	7	8:30 am
JR SHOW NV IN	7	10:55 am	12	10:05 am	2	1:05 pm	6	8:30 am
JR SHOW NV JR	7	10:55 am	12	10:05 am	2	1:05 pm	6	8:30 am
JR SHOW NV SR	7	10:55 am	12	10:05 am	2	1:05 pm	6	8:30 am
JR SHOW OP IN	7	10:55 am	12	10:05 am	2	1:05 pm	6	8:30 am
JR SHOW OP JR	7	10:55 am	12	10:05 am	2	1:05 pm	6	8:30 am
JR SHOW OP SR	7	10:55 am	12	10:05 am	2	1:05 pm	6	8:30 am
KEESHOND	7	10:00 am	4	12:55 pm	9	1:55 pm	9	2:00 pm
KERRY BLUE	8	12:55 pm	6	12:55 pm	5	10:25 am	5	9:40 am
LABRADOR	12	10:05 am	12	9:00 am	2	10:25 am	3	1:55 pm
LAKELND TERR	8	12:55 pm	6	12:55 pm	5	1:00 pm	5	10:40 am
LHASA	7	10:00 am	5	12:55 pm	10	1:00 pm	9	2:00 pm
MALTESE	4	12:55 pm	6	3:15 pm	4	12:35 pm	6	11:20 am
MANCH TERR-STD	11	12:50 pm	6	12:55 pm	5	2:00 pm	5	12:40 pm
MANCH TERR-TOY	4	12:55 pm	6	3:15 pm	4	2:10 pm	6	11:20 am
MASTIFF	1	10:20 am	8	9:00 am	3	9:00 am	3	10:10 am
MIN PIN	7	9:00 am	6	9:00 am	7	9:00 am	7	8:30 am
MIN SCHN	11	10:10 am	6	11:10 am	5	2:00 pm	5	12:40 pm
NEWF	10	10:05 am	8	9:00 am	3	10:40 am	8	12:45 pm
NOR ELK HND	8	11:20 am					10	12:50 pm
NOR LUN	3	11:15 am	11	9:00 am	7	2:45 pm	7	9:40 am
NORFOLK TERR	6	1:40 pm	5	1:55 pm	7	10:10 am	11	10:50 am
NORFOLK TERR					7	10:20 am		
NORWICH TERR	6	10:00 am	5	10:15 am	7	12:05 pm	11	8:30 am
NORWICH TERR					7	12:50 pm		
NOVA SCOTIA	3	1:00 pm	2	9:00 am	10	2:15 pm	1	9:45 am
OLD ENGLISH SHP	11	12:50 pm	9	2:20 pm	8	10:40 am	1	10:45 am
OTTERHND	8	10:10 am	11	1:45 pm	10	2:15 pm	10	12:50 pm
PAPILLON	5	3:00 pm	3	12:55 pm	12	9:00 am	4	10:05 am
PARSON RUSSELL	7	10:00 am	6	12:55 pm	5	2:00 pm	11	1:00 pm

## JUDGING PROGRAM BY ALPHABETICAL ORDER

BREED	THR		FRI		SAT		SUN	
	RING	TIME	RING	TIME	RING	TIME	RING	TIME
PEKINGESE	7	10:00 am	6	12:55 pm	7	11:40 am	6	11:20 am
PEMB WELSH CORG	1	9:00 am	11	9:00 am	2	10:25 am	2	8:30 am
PER INCA OR			3	12:55 pm			2	12:50 pm
PET BAS GRI VEN	8	11:20 am	11	9:00 am	10	1:00 pm	10	11:00 am
PHARAOH HND	8	11:20 am	11	1:45 pm	10	2:15 pm	10	12:50 pm
POINTER	9	9:00 am	1	12:10 pm	11	10:15 am	1	8:30 am
POM	7	12:35 pm	3	12:55 pm	12	1:00 pm	4	12:35 pm
POOD MIN	10	11:15 am	12	11:15 am	6	10:00 am	3	11:15 am
POOD STD	10	12:50 pm	12	12:50 pm	6	12:55 pm	6	3:15 pm
POOD TOY	10	2:10 pm	7	10:00 am	6	3:40 pm	6	12:55 pm
PORT WATERDOG	10	10:05 am	8	9:00 am	3	12:40 pm	8	12:45 pm
PUG	7	9:00 am	6	9:00 am	7	9:00 am	1	9:45 am
PULIK	11	10:10 am	4	12:55 pm	8	12:40 pm	6	1:55 pm
RHORIDGE	8	10:10 am	10	10:30 am	10	2:15 pm	11	8:30 am
ROTTWEILER	2	9:00 am	8	10:05 am	3	9:00 am	8	11:00 am
SALUKI	8	10:10 am	10	10:30 am	10	2:15 pm	11	1:00 pm
SAMOYED	10	2:10 pm	8	11:20 am	3	12:40 pm	8	12:45 pm
SCHIPPERKE	7	9:00 am	4	10:25 am	11	11:30 am	4	12:35 pm
SCOTTISH TERR	6	11:15 am	6	10:00 am	5	11:30 am	5	10:40 am
SEALYHM TERR					5	2:00 pm		
SHETLD SHEEP	11	11:20 am	11	12:45 pm	9	1:55 pm	3	12:50 pm
SHIBA INU	7	10:00 am	4	12:55 pm	11	11:30 am	4	12:35 pm
SHIH TZU	7	10:00 am	5	10:15 am	6	11:40 am	6	11:20 am
SIB HUSKY	10	12:50 pm	8	11:20 am	3	10:40 am	8	12:45 pm
SILKY TERR	5	10:00 am	5	9:00 am	6	10:00 am	1	9:45 am
SKYE TERR	7	10:00 am	6	12:55 pm	5	2:00 pm	11	1:00 pm
SOFT-CTD WHEAT	8	12:55 pm	6	1:50 pm	5	10:25 am	5	9:40 am
STAF BULL	6	9:00 am	6	9:00 am	5	10:25 am	5	8:30 am
STD SCHN	10	12:50 pm	8	10:05 am	3	12:40 pm	8	12:45 pm
SWEDISH VALL	11	9:00 am	5	9:00 am	5	11:30 am	11	10:50 am
TIB SPAN	1	10:20 am	4	11:30 am	10	1:00 pm	4	12:35 pm
TIB TERR	1	10:20 am	4	12:55 pm	11	11:30 am	4	12:35 pm
TOY FOX	5	10:00 am	5	9:00 am	6	9:00 am	6	9:30 am
VIZSLA	10	9:00 am	9	12:55 pm	10	10:20 am	9	8:30 am
WEIM	10	9:00 am	3	11:15 am	1	9:00 am	9	9:30 am
WELSH TER	8	12:55 pm	6	12:55 pm	5	2:00 pm	5	12:40 pm
WEST HIGHLND	8	12:55 pm	6	10:00 am	5	2:00 pm	5	10:40 am
WHIPPET	12	9:00 am	1	10:05 am	2	9:25 am	9	11:10 am
XOLOS	3	1:00 pm	11	1:45 pm	7	2:45 pm	7	9:40 am
YORKSH TERR	5	11:15 am	4	2:00 pm	6	12:55 pm	6	9:30 am
YORKSH TERR	5	12:30 pm						

### ROUTES TO THE SHOW

**FROM THE NORTH** - I-35 S, to exit 160; Left on AT&T Parkway, Right on E. Houston past the Coliseum, Right at West Gate entrance. Do not cross RR Tracks.

**FROM THE SOUTH** - I-37 N, Exit 139 onto I-10 E. Exit 579; merge into I-10 Frontage Road, Left on E. Houston past the Coliseum, Right at West Gate entrance. Do not cross RR Tracks.

**FROM THE SOUTH** - I-35 N, Exit 159 B; Right on AT&T Parkway, Right on E. Houston past the Coliseum, Right at West Gate entrance. Do not cross RR Tracks.

**FROM THE EAST** - I-10 W to Exit 579. Right on E. Commerce, Right on E. Houston past the Coliseum, Right at West Gate entrance. Do not cross RR Tracks.

**FROM THE WEST** - I-10 E, to Exit 570; merge into I-35 N to exit 159 B. Right on AT&T Parkway, Right on E. Houston past the Coliseum, Right at West Gate entrance. Do not cross RR Tracks.

**FROM THE WEST** - 290 S/I-37 S, Exit 159 B; Right on AT&T Parkway, Right on E. Houston past the Coliseum, Right at West Gate entrance. Do not cross RR Tracks.

## JUDGES

Miss Maxine V Beam .....	3201 River Park Dr Apt 1030, Fort Worth TX 76116
Mr Edd Embry Bivin .....	4108 Pebblebrook Ct, Fort Worth TX 76109
Ms Deborah V Boyd .....	90 Millsaps Pl, Kenner LA 70065
Mr Danny J Bussard .....	12106 White Birch Lane, San Antonio TX 78245
Mr Rick Carr .....	33246 Hannibal Rd, Fulshear TX 77441
Mrs Susan L Clemons .....	5400 Spotted Dog Trl, Chino Valley AZ 86323
Mr Jon R Cole .....	PO Box 160205, Nashville TN 37216
Mr Michael H Faulkner .....	PO Box 208, Center Cross VA 22437
Mr Neil Feerrar .....	200 Circle Dr, Lock Haven PA 17745
Mrs Judith Felton .....	25 Columbus Rd, Demarest NJ 07627
Mrs Jean Fournier .....	PO Box 369, Calhoun GA 30703
Mr Vincent T Grosso .....	1828 Litchfield Ct, Banning CA 92220
Mrs Kathleen M Grosso .....	1828 Litchfield Ct, Banning CA 92220
Mrs Keke Kahn .....	1723 Starling Dr, Sarasota FL 34231
Mrs Janice Keith .....	7403 Rustling Oaks Dr, Richmond TX 77469
Ms Sue N Melancon .....	4208 Troy St, Metairie LA 70001
Ms Magda Omansky .....	81 Oakwood Dr, Murray Hill NJ 07974
Mrs Charlotte P Patterson .....	836 N Lakeside Dr, Destin FL 32541
Mrs Marilyn Y Pipes .....	350 County Road 509, Stephenville TX 76401
Ms Jane Roppolo .....	613 Crossroads Blvd, Bossier City LA 71111
Daniel G Sena DDS .....	5430 Richmond Ave, Dallas TX 75205
Dr Robert D Smith .....	PO Box 309, Saint Stephens Church VA 23148
Mrs Susan St John-Brown .....	3815 State Route 350, Lebanon OH 45036
Mr Robert Stein .....	61630 Toro Canyon Way, La Quinta CA 92253
Mr Colin Wildy .....	6800 Benton Ct, Arvado CO 80003

## VARIETY GROUP JUDGES

### ALAMO AREA TOY DOG CLUB, INC.-WEDNESDAY

Miss Maxine V Beam .....	Toy Group
--------------------------	-----------

### BEXAR COUNTY KENNEL CLUB, INC. (1)-THURSDAY

Mr Susan St John-Brown .....	Sporting Group
Ms Jane Roppolo .....	Hound Group
Mr Robert Stein .....	Working Group
Mr Jon R Cole .....	Terrier Group
Mrs Keke Kahn .....	Toy Group
Mrs Charlotte P Patterson .....	Non-Sporting Group
Mrs Jean Fournier .....	Herding Group
Mr Edd Embry Bivin .....	Best In Show

### COMAL COUNTY KENNEL CLUB, INC. (1)-FRIDAY

Mr Edd Embry Bivin .....	Sporting Group
Mr Robert Stein .....	Hound Group
Ms Jane Roppolo .....	Working Group
Mrs Charlotte P Patterson .....	Terrier Group
Mrs Jean Fournier .....	Toy Group
Mrs Keke Kahn .....	Non-Sporting Group
Mr Jon R Cole .....	Herding Group
Mrs Kathleen M Grosso .....	Best In Show

**BEXAR COUNTY KENNEL CLUB, INC. (2)-SATURDAY**

Ms Jane Roppolo .....	Sporting Group
Mrs Susan St John-Brown .....	Hound Group
Mrs Keke Kahn .....	Working Group
Mrs Kathleen M Grosso .....	Terrier Group
Mr Edd Embry Bivin .....	Toy Group
Mrs Jean Fournier .....	Non-Sporting Group
Mr Robert Stein .....	Herding Group
Mr Jon R Cole .....	Best In Show

**COMAL COUNTY KENNEL CLUB, INC. (2)-SUNDAY**

Mr Jon R Cole .....	Sporting Group
Mrs Keke Kahn .....	Hound Group
Mrs Jean Fournier .....	Working Group
Mr Edd Embry Bivin .....	Terrier Group
Mrs Kathleen M Grosso .....	Toy Group
Mr Robert Stein .....	Non-Sporting Group
Mr Vincent T Grosso .....	Herding Group
Mr Michael H Faulkner .....	Best In Show

**SCREENING CLINICS**

Sponsored by the Yorkshire Terrier Club of America

**CERF - OFA PATELLAR**

**MICRO CHIPPING**

OPEN TO ALL BREEDS

**Please PRE-PREGISTER**

Name .....

Breed .....

Preferred Time .....

Number of Dogs .....

email: [crystalam1@yahoo.com](mailto:crystalam1@yahoo.com) or (719) 671-8715

**WALK INS By Availability**

Cash, Checks or PayPal

**CERF Screening**

**Thursday, July 14 • Hours 1:00-5:00 pm**

Dr Lynsey Smith DACVO

\$30.00 per dog

**OFA Patellar Clinic & Micro Chipping**

**Friday, July 15 • Hours 12:00-2:00 pm**

Dr Erin Whitacre DVM

**No Charge for Yorkshire Terriers**

**\$25.00 for all other Breeds.**

Discounted OFA Fee for all participating

**Micro Chips \$20.00 each**

**RIVER CITY INDEPENDENT SPECIALTIES**  
**Wednesday, July 13, 2011**

**JUDGING PROGRAM**

The number before each Breed (Variety) indicates the number of dogs entered in that Breed (Variety). The numbers following each Breed (Variety) indicates the number of Regular Class Dogs, Regular Class Bitches, Best of Breed (Variety) (Dogs-Bitches).

There are 179 dogs entered in this show with a total of 214 entries.

**YORKSHIRE TERRIER CLUB  
OF AMERICA, INC. - 2011078003  
RING 5**

**DR ROBERT D SMITH (85)**

**1:00 pm**

- 85 Yorkshire Terriers 26-35-13-9
- 1 Veteran Dog
- 1 Brood Bitch

**SAN ANTONIO ENGLISH SPRINGER  
SPANIEL CLUB, INC. - 2011049701  
RING 9**

**MS DEBORAH V BOYD (12)**

**2:00 pm**

- 9 Spaniels (English Springer) Sweepstakes Entries
- 3 Spaniels (English Springer) Veterans Sweepstakes Entries

**MRS JEAN FOURNIER (33)**

**2:30 pm**

- 33 Spaniels (English Springer) 9-14-4-3
- 3 Veteran Dogs

**GERMAN SHORTHAIRED POINTER CLUB  
OF SAN ANTONIO - 2011049605  
RING 9**

**MS SUE N MELANCON (10)**

**4:00 pm**

- 10 Pointers (German Shorthaired) Sweepstakes Entries

**MRS JEAN FOURNIER (30)**

- 30 Pointers (German Shorthaired) 6-13-9-2

**ALAMO BRITTANY CLUB - 2011147001  
RING 9**

**MS SUE N MELANCON (9)**

**5:45 pm**

- 9 Brittany Sweepstakes Entries

**MRS JEAN FOURNIER (35)**

- 1 Open Intermediate
- 1 Novice Intermediate
- 1 Novice Junior
- 32 Brittany 12-13-5-2

**ALAMO AREA TOY DOG CLUB, INC.**  
**Wednesday, July 13, 2011**

## JUDGING PROGRAM

The number before each Breed (Variety) indicates the number of dogs entered in that Breed (Variety). The numbers following each Breed (Variety) indicates the number of Regular Class Dogs, Regular Class Bitches, Best of Breed (Variety) (Dogs-Bitches).

**OFFICIAL NOTICE: Additional Judges.**

Reference Chapter 7, Section 13 of AKC Rules: Owner has the right to withdraw his entry and have his entry fee refunded provided notification of his withdrawal is received no later than one half-hour prior to the start of any regular conformation judging.

Mr Danny J Bussard will judge Brussels Griffons, Italian Greyhounds, Japanese Chin, Maltese, Miniature Pinschers, Pomeranians and Shih Tzu in place of Mrs Susan St John-Brown.

There are 292 dogs entered in this show with a total of 294 entries.

**RING 5**  
**MISS MAXINE V BEAM (69)**

**9:00 am**

67 Yorkshire Terriers 20-27-11-9

**11:40 am**

- 1 Open Senior
- 1 Open Intermediate

**RING 6**  
**MRS SUSAN ST JOHN-BROWN (175)**

**9:00 am**

- 3 Affenpinschers 1-0-2-0
- 36 Cavalier King Charles Spaniels 13-18-5-0

**10:35 am**

- 20 Chihuahuas (Long Coat) 8-8-3-1
- 15 Chihuahuas (Smooth Coat) 5-5-3-2

**12:00 pm**

LUNCH

**12:45 pm**

- 1 English Toy Spaniels (B & P C) 0-0-1-0
- 3 English Toy Spaniels (K C & R) 0-2-1-0
- 16 Chinese Cresteds 6-7-1-2
- 10 Havanese 0-8-2-0

**1:55 pm**

- 3 Pekingese 0-1-2-0
- 24 Papillons 5-15-1-3

**3:00 pm**

- 20 Poodles (Toy) 8-10-0-2
- 13 Silky Terriers 6-1-3-3
- 6 Pugs 3-1-0-2
- 5 Toy Fox Terriers 2-2-1-0

**RING 7**  
**MR DANNY J BUSSARD (50)**

**1:00 pm**

- 6 Italian Greyhounds 1-2-2-1
- 5 Miniature Pinschers 3-1-1-0
- 8 Brussels Griffons 3-3-0-2
- 9 Japanese Chin 3-2-4-0

**2:05 pm**

- 1 Maltese 0-0-0-1
- 13 Pomeranians 5-4-3-1
- 8 Shih Tzu 1-6-1-0

**GROUP RING**

**4:15 pm**

TOY VARIETY GROUP

**RIVER CITY INDEPENDENT SPECIALTIES**  
**Friday, July 15, 2011**

**JUDGING PROGRAM**

The number before each Breed (Variety) indicates the number of dogs entered in that Breed (Variety). The numbers following each Breed (Variety) indicates the number of Regular Class Dogs, Regular Class Bitches, Best of Breed (Variety) (Dogs-Bitches).

There are 26 dogs entered in this show with a total of 30 entries.

**DOBERMAN PINSCHER CLUB OF  
SAN ANTONIO - 2011080302  
RING 8**

**MRS JANICE KEITH (3)**

**12:35 pm**

- 3 Doberman Pinschers Sweepstakes Entries

**MR EDD EMBRY BIVIN (27)**

**12:45 pm**

- 1 Open Senior
- 26 Doberman Pinschers 7-13-2-3
- 1 Veteran Bitch

**RIVER CITY INDEPENDENT SPECIALTIES**  
**Saturday, July 16, 2011**

**JUDGING PROGRAM**

The number before each Breed (Variety) indicates the number of dogs entered in that Breed (Variety). The numbers following each Breed (Variety) indicates the number of Regular Class Dogs, Regular Class Bitches, Best of Breed (Variety) (Dogs-Bitches).

There are 107 dogs entered in this show with a total of 124 entries.

**GERMAN SHORTHAIRED POINTER  
CLUB OF AMERICA - 2011149822  
RING 1**

**MR COLIN WILDY (10)**

**1:30 pm**

- 9 Pointers (German Shorthaired) Sweepstakes Entries
- 1 Pointers (German Shorthaired) Veterans Sweepstakes Entry

**MRS KEKE KAHN (34)**

- 33 Pointers (German Shorthaired) 6-14-10-2
- 1 Veteran Dog
- 1 Open Senior

**ALAMO GREAT DANE CLUB, INC. - 2011049401  
RING 8**

**MRS JEAN FOURNIER (46)**

**2:45 pm**

- 46 Great Danes 19-18-8-1

**ALAMO PAPILLON SOCIETY - 2011494701  
RING 12**

**MR RICK CARR (6)**

**3:35 pm**

- 6 Papillons Sweepstakes Entries

**MRS CHARLOTTE P PATTERSON (28)**

**3:35 pm**

- 28 Papillons 5-17-2-1
- 2 Veteran Dogs
- 1 Veteran Bitch

# BEXAR COUNTY KENNEL CLUB, INC.

Thursday, July 14, 2011

## JUDGING PROGRAM

The number before each Breed (Variety) indicates the number of dogs entered in that Breed (Variety). The numbers following each Breed (Variety) indicates the number of Regular Class Dogs, Regular Class Bitches, Best of Breed (Variety) (Dogs-Bitches).

### OFFICIAL NOTICE: Additional Judges.

Reference Chapter 7, Section 13 of AKC Rules: Owner has the right to withdraw his entry and have his entry fee refunded provided notification of his withdrawal is received no later than one half-hour prior to the start of any regular conformation judging.

Mrs Jane Roppolo will judge Spaniels (English Springer) and Mr Danny J Bussard will judge Silky Terriers and Toy Fox Terriers in place of Mrs Keke Kahn.

There are 1349 dogs entered in this show with a total of 1405 entries.

### RING 1 MRS JEAN FOURNIER (80)

#### 9:00 am

- 18 French Bulldogs 4-7-6-1
- 16 Pembroke Welsh Corgis 5-6-3-2

#### 10:20 am

- 5 Tibetan Spaniels 1-0-2-2
- 6 American Eskimo Dogs 1-4-0-1
- 3 Tibetan Terriers 1-1-0-1
- 13 Mastiffs 4-6-2-1

#### 11:25 am

- 1 Great Pyrenees 0-0-1-0
- 1 Black Russian Terriers 0-0-1-0
- 7 Akitas 1-3-2-1
- 10 Giant Schnauzers 1-4-3-2

### RING 2 MR VINCENT T GROSSO (87)

#### 9:00 am

- 7 Bullmastiffs 1-4-2-0
- 21 Rottweilers 7-11-2-1

#### 10:05 am

- 3 Dogues de Bordeaux 1-2-0-0
- 25 Doberman Pinschers 7-13-1-4

#### 11:15 am

- 1 German Pinschers 0-0-1-0
- 1 Greater Swiss Mountain Dogs 1-0-0-0
- 29 Great Danes 11-10-7-1

### RING 3 MR JON R COLE (157)

#### 9:00 am

- 30 Pointers (German Shorthaired) 6-14-8-2

#### 10:10 am

- 5 Cane Corso 3-0-1-1
- 22 Boxers 9-9-1-3

#### 11:15 am

- 8 Norwegian Lundehunds 3-4-1-0
- 7 Setters (Irish) 2-2-2-1
- 9 Finnish Lapphunds 2-7-0-0

#### 12:15 pm

#### LUNCH

#### 1:00 pm

- 1 Belgian Malinois 0-0-0-1
- 1 Setters (English) 1-0-0-0
- 3 Belgian Tervuren 0-1-2-0
- 2 Xoloitzcuintli 0-2-0-0
- 2 Setters (Gordon) 0-1-1-0

- 4 Retrievers (Nova Scotia Duck Tolling) 0-2-2-0
- 8 Belgian Sheepdogs 1-3-3-1
- 55 Retrievers (Golden) 22-24-7-1
- 1 Brace

### RING 4 MRS KATHLEEN M GROSSO (134)

#### 9:00 am

- 7 Italian Greyhounds 1-3-2-1
- 16 Chihuahuas (Smooth Coat) 6-4-3-3
- 14 Chihuahuas (Long Coat) 4-6-3-1

#### 10:30 am

- 13 Japanese Chin 5-2-4-1
- 1 Brace
- 16 Chinese Cresteds 7-5-2-2

#### 11:40 am

- 12 Havanese 1-9-2-0

#### 12:10 pm

#### LUNCH

#### 12:55 pm

- 1 English Toy Spaniels (B & P C) 0-0-1-0
- 3 Affenpinschers 1-0-2-0
- 3 English Toy Spaniels (K C & R) 0-2-1-0
- 4 Maltese 1-2-0-1
- 8 Brussels Griffons 3-3-0-2
- 36 Cavalier King Charles Spaniels 12-18-5-0
- 1 Brace
- 1 Manchester Terriers (Toy) 0-1-0-0

### RING 5 MR DANNY J BUSSARD (20)

#### 10:00 am

- 3 Toy Fox Terriers 1-0-2-0
- 17 Silky Terriers 7-3-3-4

### RING 5 MR NEIL FEERRAR (31)

#### 11:15 am

- 31 Yorkshire Terriers Sweepstakes Entries

### RING 5 MRS KEKE KAHN (174)

#### 12:30 pm

- 70 Yorkshire Terriers 24-30-10-6

#### 3:00 pm

- 4 Bichons Frises 1-2-1-0
- 26 Papillons 9-13-1-3
- MRS KAHN IS ALSO IN RING 9

**BEXAR COUNTY KENNEL CLUB, INC.****Thursday, July 14, 2011****RING 6  
MS JANE ROPPOLO (133)****9:00 am**

- 22 American Staffordshire Terriers 13-7-1-1
- 3 Staffordshire Bull Terriers 0-1-2-0

**10:00 am**

- 32 Norwich Terriers 8-13-9-2

**11:15 am**

- 3 Fox Terriers (Wire) 0-1-2-0
  - 6 Border Terriers 0-3-0-3
  - 9 Scottish Terriers 2-6-1-0
  - 3 Fox Terriers (Smooth) 0-0-3-0
- MS ROPPOLO GOES TO LUNCH  
MS ROPPOLO MOVES TO RING 8

**RING 6  
MR ROBERT STEIN (127)****1:40 pm**

- 18 Norfolk Terriers 2-5-2-9
- MR STEIN IS ALSO IN RING 11

**RING 7  
MRS CHARLOTTE P PATTERSON (82)****9:00 am**

- 6 Pugs 3-1-0-2
- 9 Miniature Pinschers 4-3-2-0
- 10 Schipperkes 0-7-2-1

**10:00 am**

- 1 Parson Russell Terriers 0-0-1-0
- 1 Skye Terriers 0-0-1-0
- 3 Shiba Inu 0-0-2-1
- 3 Pekingese 0-1-2-0
- 4 Lhasa Apsos 1-0-3-0
- 6 Shih Tzu 0-4-2-0
- 5 Keeshonden 0-2-3-0

**10:55 am**

- 9 Open Senior
- 5 Open Intermediate
- 1 Open Junior
- 1 Novice Senior
- 2 Novice Intermediate
- 1 Novice Junior

**11:50 am**

LUNCH

**12:35 pm**

- 15 Pomeranians 7-3-4-1

**RING 8  
MRS SUSAN ST JOHN-BROWN (98)****9:00 am**

- 8 Basset Hounds 3-2-1-1
- 1 Brace
- 15 Bulldogs 6-6-1-2
- 6 Chow Chows 0-2-2-1
- 1 Brace

**10:10 am**

- 3 Otterhounds 1-0-1-0
- 1 Brace
- 3 Salukis 1-0-1-1
- 7 Dalmatians 1-3-0-3
- 16 Rhodesian Ridgebacks 5-7-3-1

**11:20 am**

- 1 Pharaoh Hounds 0-0-1-0
- 1 Ibizan Hounds 0-0-1-0
- 1 American Foxhounds 0-0-1-0
- 1 Harriers 0-0-1-0
- 1 Irish Wolfhounds 1-0-0-0
- 1 Norwegian Elkhounds 1-0-0-0
- 4 Borzois 2-0-2-0
- 2 Beagles (13 Inch) 0-1-0-1
- 9 Petits Bassets Griffons Vendéens 2-2-3-2
- 2 Beagles (15 Inch) 0-1-1-0
- 17 Boston Terriers 6-6-3-2

**RING 8  
MS JANE ROPPOLO****12:55 pm**

- 1 Bedlington Terriers 0-0-0-1
  - 3 Lakeland Terriers 1-2-0-0
  - 4 West Highland White Terriers 0-2-1-1
  - 4 Welsh Terriers 3-1-0-0
  - 1 Dogo Argentine (Misc. Bitch)
  - 1 Anatolian Shepherd Dogs 0-1-0-0
  - 1 Bernese Mountain Dogs 0-0-1-0
  - 2 Airedale Terriers 0-0-1-1
  - 5 Kerry Blue Terriers 1-2-2-0
  - 7 Soft Coated Wheaten Terriers 2-2-1-2
  - 26 Spaniels (English Springer) 6-14-4-2
- MS ROPPOLO IS ALSO IN RING 6

**RING 9  
MRS KEKE KAHN****9:00 am**

- 9 Pointers 5-1-2-1
- 30 Brittany's 11-11-5-3

**10:25 am**

- 4 Chinese Shar-Pei 1-1-0-2
  - 1 Pointers (German Wirehaired) 0-0-1-0
  - 3 Retrievers (Flat-Coated) 0-2-1-0
  - 27 Australian Shepherds 7-15-4-1
- MRS KAHN GOES TO LUNCH  
MRS KAHN MOVES TO RING 5

**RING 10  
MISS MAXINE V BEAM (166)****9:00 am**

- 13 Vizslas 3-3-4-3
- 15 Weimaraners 4-9-2-0

**10:05 am**

- 4 Spaniels (Clumber) 1-1-2-0
- 6 Newfoundlands 2-2-1-1
- 7 Portuguese Water Dogs 1-2-4-0
- 12 Spaniels (Cocker) Black 2-8-2-0

**11:15 am**

- 20 Poodles (Miniature) 5-10-4-1

**12:05 pm**

LUNCH

**12:50 pm**

- 3 Standard Schnauzers 0-2-1-0
- 3 Spaniels (Boykin) 0-2-1-0
- 6 Siberian Huskies 2-1-2-1
- 21 Poodles (Standard) 4-11-2-4

**BEXAR COUNTY KENNEL CLUB, INC.**

**Thursday, July 14, 2011**

**2:10 pm**

- 7 Samoyeds 3-1-2-1
- 2 Spaniels (Cocker) Parti-Color 0-1-0-1
- 12 Spaniels (English Cocker) 3-6-2-1
- 14 Spaniels (Cocker) Ascob 3-9-2-0
- 21 Poodles (Toy) 9-10-0-2

**RING 11  
MR ROBERT STEIN**

**9:00 am**

- 5 Bull Terriers (Colored) 1-1-1-2
- 8 Retrievers (Chesapeake Bay) 0-4-2-2
- 11 Border Collies 4-0-6-1
- 4 Swedish Vallhunds 1-0-2-1
- 5 Cardigan Welsh Corgis 2-2-0-1

**10:10 am**

- 25 Miniature Schnauzers 8-12-5-0
- 1 Australian Terriers 0-0-1-0
- 2 Pulik 1-0-1-0
- 5 Cairn Terriers 0-2-1-2

**11:20 am**

- 22 Shetland Sheepdogs 8-12-1-1

**12:05 pm**

LUNCH

**12:50 pm**

- 1 Manchester Terriers (Standard) 0-0-1-0
  - 2 Collies (Rough) 0-0-1-1
  - 1 Beaucerons 0-0-0-1
  - 2 Old English Sheepdogs 1-0-1-0
  - 3 Briards 0-2-1-0
  - 1 Collies (Smooth) 0-0-1-0
  - 11 Bouviers des Flandres 2-4-3-2
- MR STEIN MOVES TO RING 6

**RING 12  
MR EDD EMBRY BIVIN (116)**

**9:00 am**

- 4 Dachshunds (Smooth) 0-3-0-1
- 5 Basenjis 1-2-1-1
- 5 Dachshunds (Longhaired) 1-2-2-0
- 13 Whippets 4-6-2-1

**10:05 am**

- 3 Dachshunds (Wirehaired) 1-0-0-2
- 23 Retrievers (Labrador) 5-15-1-2

**11:05 am**

- 25 German Shepherd Dogs 7-13-2-3

**12:05 pm**

LUNCH

**12:50 pm**

- 4 Bearded Collies 0-1-1-2
- 7 Greyhounds 1-4-1-1
- 6 Australian Cattle Dogs 1-2-1-2
- 21 Afghan Hounds 9-5-3-4

**GROUP RING**

**2:30 pm**

VARIETY GROUP JUDGING  
Order will be announced by 2:00 pm

# COMAL COUNTY KENNEL CLUB, INC.

Friday, July 15, 2011

## JUDGING PROGRAM

The number before each Breed (Variety) indicates the number of dogs entered in that Breed (Variety). The numbers following each Breed (Variety) indicates the number of Regular Class Dogs, Regular Class Bitches, Best of Breed (Variety) (Dogs-Bitches).

There are 1460 dogs entered in this show with a total of 1483 entries.

### RING 1 MR ROBERT STEIN (93)

#### 9:00 am

- 6 Basset Hounds 2-2-1-1
- 3 Dogues de Bordeaux 1-2-0-0
- 8 Greyhounds 1-4-2-1
- 8 Australian Cattle Dogs 2-3-1-2
- 6 Bullmastiffs 0-4-2-0

#### 10:05 am

- 2 Dachshunds (Wirehaired) 1-0-0-1
- 16 Whippets 5-6-4-1
- 5 Dachshunds (Longhaired) 1-2-2-0
- 7 Basenjis 2-3-1-1

#### 11:05 am

- 5 Dachshunds (Smooth) 0-4-0-1
- 1 German Pinschers 0-0-1-0
- 1 Belgian Malinois 0-0-0-1
- 1 Greater Swiss Mountain Dogs 1-0-0-0
- 1 Great Pyrenees 0-0-1-0
- 1 Black Russian Terriers 0-0-1-0
- 3 Belgian Tervuren 0-1-2-0
- 8 Borzois 4-1-3-0
- 11 Belgian Sheepdogs 1-4-5-1

### RING 1 MS SUE N MELANCON (17)

#### 12:10 pm

- 9 Pointers 5-1-2-1
- 8 Setters (Irish) 3-3-2-0

### RING 2 MRS MARILYN Y PIPES (95)

#### 9:00 am

- 4 Retrievers (Nova Scotia Duck Tolling) 0-2-2-0
- 9 Retrievers (Chesapeake Bay) 0-4-2-3
- 58 Retrievers (Golden) 22-27-7-2

#### 11:50 am

- 24 Spaniels (English Springer) 7-11-4-2

### RING 3 MRS JEAN FOURNIER (131)

#### 9:00 am

- 31 Doberman Pinschers 9-16-2-4

#### 10:15 am

- 25 German Shepherd Dogs 7-13-2-3

#### 11:15 am

- 5 Cane Corso 3-0-1-1
- 19 Weimaraners 7-9-3-0

#### 12:10 pm

LUNCH

#### 12:55 pm

- 1 Dogo Argentine (Misc. Bitch)
- 1 Peruvian Inca Orchids (Misc. Dog)

- 2 Peruvian Inca Orchids (Misc. Bitches)
- 4 Bearded Collies 0-1-1-2
- 13 Pomeranians 6-3-3-1
- 30 Papillons 9-17-1-3

### RING 4 MR VINCENT T GROSSO (135)

#### 9:00 am

- 17 Bulldogs 8-6-1-2
- 19 French Bulldogs 5-7-6-1

#### 10:25 am

- 15 Boston Terriers 5-5-3-2
- 11 Schipperkes 0-8-2-1

#### 11:30 am

- 9 Tibetan Spaniels 4-1-2-2
- 7 Cardigan Welsh Corgis 3-3-0-1

#### 12:10 pm

LUNCH

#### 12:55 pm

- 2 Pulik 1-0-1-0
  - 2 Shiba Inu 0-0-1-1
  - 3 Tibetan Terriers 1-1-0-1
  - 6 Cairn Terriers 0-3-1-2
  - 6 Keeshonden 0-3-3-0
  - 1 Bernese Mountain Dogs 0-0-1-0
  - 2 Alaskan Malamutes 0-0-1-1
  - 3 Anatolian Shepherd Dogs 0-1-2-0
- MR GROSSO MOVES TO RING 9

### RING 4 MR JON R COLE (157)

#### 2:00 pm

- 53 Yorkshire Terriers 14-26-9-4
- MR COLE IS ALSO IN RING 5

### RING 5 MR JON R COLE

#### 9:00 am

- 2 Beagles (13 Inch) 0-1-0-1
- 6 Toy Fox Terriers 1-2-3-0
- 2 Beagles (15 Inch) 0-1-1-0
- 5 Swedish Vallhunds 2-0-2-1
- 17 Silky Terriers 7-3-3-4

#### 10:15 am

- 7 Shih Tzu 1-5-1-0
- 40 Norwich Terriers 11-16-10-3

#### 12:10 pm

LUNCH

#### 12:55 pm

- 4 Spaniels (Clumber) 1-1-2-0
  - 3 Spaniels (Boykin) 0-2-1-0
  - 7 Akitas 1-3-2-1
  - 3 Lhasa Apsos 0-0-3-0
  - 8 Brussels Griffons 3-3-0-2
- MR COLE MOVES TO RING 4

**COMAL COUNTY KENNEL CLUB, INC.**

**Friday, July 15, 2011**

**RING 5  
MS JANE ROPPOLO (113)**

**1:55 pm**

- 19 Norfolk Terriers 2-6-2-9
- MS ROPPOLO IS ALSO IN RING 10

**RING 6  
MRS KATHLEEN M GROSSO (100)**

**9:00 am**

- 3 Staffordshire Bull Terriers 0-1-2-0
- 5 Bull Terriers (Colored) 1-1-1-2
- 6 Pugs 3-1-0-2
- 12 Miniature Pinschers 6-3-2-1

**10:00 am**

- 4 Fox Terriers (Smooth) 1-0-3-0
- 5 West Highland White Terriers 1-2-1-1
- 7 Border Terriers 1-3-0-3
- 12 Scottish Terriers 3-7-2-0

**11:10 am**

- 25 Miniature Schnauzers 8-12-5-0

**12:10 pm**

LUNCH

**12:55 pm**

- 5 Kerry Blue Terriers 1-2-2-0
- 1 Bedlington Terriers 0-0-0-1
- 1 Skye Terriers 0-0-1-0
- 1 Australian Terriers 0-0-1-0
- 2 Welsh Terriers 1-1-0-0
- 3 Fox Terriers (Wire) 0-1-2-0
- 3 Pekingese 0-1-2-0
- 3 Lakeland Terriers 1-2-0-0
- 1 Manchester Terriers (Standard) 0-0-1-0
- 1 Parson Russell Terriers 0-0-1-0

**RING 6  
MR EDD EMBRY BIVIN (146)**

**1:50 pm**

- 7 Soft Coated Wheaten Terriers 2-2-1-2
- 9 Chow Chows 3-3-2-1
- 7 Dalmatians 1-3-0-3
- 12 Chihuahuas (Long Coat) 3-6-2-1

**3:15 pm**

- 4 Maltese 1-2-0-1
- 16 Chihuahuas (Smooth Coat) 5-5-4-2
- 15 Japanese Chin 5-4-4-2
- 1 Manchester Terriers (Toy) 0-1-0-0
- MR BIVIN IS ALSO IN RING 8

**RING 7  
MRS CHARLOTTE P PATTERSON (123)**

**9:00 am**

- 25 American Staffordshire Terriers 14-8-2-1

**10:00 am**

- 23 Poodles (Toy) 10-11-0-2
- 8 Italian Greyhounds 2-3-2-1

**11:15 am**

- 3 English Toy Spaniels (K C & R) 0-2-1-0
- 6 American Eskimo Dogs 1-4-0-1
- 17 Chinese Cresteds 8-5-2-2

**12:15 pm**

LUNCH

**1:00 pm**

- 2 Airedale Terriers 0-0-1-1
- 1 English Toy Spaniels (B & P C) 0-0-1-0
- 4 Bichons Frises 1-2-1-0
- 13 Havanese 1-10-2-0
- MRS PATTERSON MOVES TO RING 8

**RING 8  
MR EDD EMBRY BIVIN**

**9:00 am**

- 13 Mastiffs 4-6-2-1
- 8 Newfoundlands 3-3-1-1
- 7 Portuguese Water Dogs 1-2-4-0

**10:05 am**

- 3 Standard Schnauzers 0-2-1-0
- 27 Rottweilers 10-14-2-1

**11:20 am**

- 7 Samoyeds 3-1-2-1
- 10 Siberian Huskies 3-2-3-2
- MR BIVIN GOES TO LUNCH
- MR BIVIN MOVES TO RING 6

**RING 8  
MRS CHARLOTTE P PATTERSON**

**1:50 pm**

- 21 Boxers 6-11-1-3
- MRS PATTERSON IS ALSO IN RING 7

**RING 9  
MRS SUSAN L CLEMONS (115)**

**9:00 am**

- 34 Pointers (German Shorthaired) 7-15-10-2

**10:20 am**

- 33 Brittanys 13-11-6-3

**11:40 am**

- 12 Spaniels (Cocker) Black 2-8-2-0

**12:10 pm**

LUNCH

**12:55 pm**

- 2 Spaniels (Cocker) Parti-Color 0-1-0-1
- 1 Pointers (German Wirehaired) 0-0-1-0
- 5 Setters (Gordon) 2-2-1-0
- 14 Vizslas 3-4-4-3
- 14 Spaniels (Cocker) Ascob 3-9-2-0

**RING 9  
MR VINCENT T GROSSO**

**2:20 pm**

- 2 Collies (Rough) 0-0-1-1
- 3 Briards 0-2-1-0
- 4 Old English Sheepdogs 1-0-2-1
- 1 Collies (Smooth) 0-0-1-0
- 11 Bouviers des Flandres 2-4-3-2
- 11 Giant Schnauzers 1-4-4-2
- MR GROSSO IS ALSO IN RING 4

**COMAL COUNTY KENNEL CLUB, INC.**  
**Friday, July 15, 2011**

**RING 10**  
**MS JANE ROPPOLO**

**9:00 am**

38 Great Danes 16-13-8-1

**10:30 am**

- 3 Salukis 1-0-1-1
- 1 Harriers 0-0-1-0
- 1 Irish Wolfhounds 1-0-0-0
- 1 American Foxhounds 0-0-1-0
- 3 Retrievers (Flat-Coated) 0-2-1-0
- 3 Ibizan Hounds 1-1-1-0
- 16 Rhodesian Ridgebacks 5-7-3-1

**11:40 am**

LUNCH

**12:25 pm**

28 Australian Shepherds 8-15-4-1  
MS ROPPOLO MOVES TO RING 5

**RING 11**  
**MRS KEKE KAHN (145)**

**9:00 am**

- 8 Norwegian Lundehunds 3-4-1-0
- 9 Petits Bassets Griffons Vendeens 2-2-3-2
- 15 Pembroke Welsh Corgis 5-6-2-2

**10:10 am**

37 Cavalier King Charles Spaniels 12-20-5-0

**11:30 am**

11 Border Collies 3-1-6-1

**12:00 pm**

LUNCH

**12:45 pm**

- 3 Affenpinschers 1-0-2-0
- 24 Shetland Sheepdogs 11-11-1-1

**1:45 pm**

- 1 Pharaoh Hounds 0-0-1-0
- 1 Beaucerons 0-0-0-1
- 1 Otterhounds 0-0-1-0
- 2 Xoloitzcuintli 0-2-0-0
- 9 Finnish Lapphunds 2-7-0-0
- 24 Afghan Hounds 9-8-3-4

**RING 12**  
**MRS SUSAN ST JOHN-BROWN (113)**

**9:00 am**

27 Retrievers (Labrador) 5-19-1-2

**10:05 am**

- 10 Open Senior
- 4 Open Intermediate
- 1 Open Junior
- 2 Novice Senior
- 2 Novice Intermediate
- 4 Novice Junior

**11:15 am**

21 Poodles (Miniature) 5-11-4-1

**12:05 pm**

LUNCH

**12:50 pm**

- 14 Spaniels (English Cocker) 3-8-2-1
- 4 Chinese Shar-Pei 1-1-0-2
- 2 Setters (English) 2-0-0-0
- 22 Poodles (Standard) 5-11-2-4

**GROUP RING**

**2:45 pm**

VARIETY GROUP JUDGING

Order will be announced by 2:15 pm

# BEXAR COUNTY KENNEL CLUB, INC.

Saturday, July 16, 2011

## JUDGING PROGRAM

The number before each Breed (Variety) indicates the number of dogs entered in that Breed (Variety). The numbers following each Breed (Variety) indicates the number of Regular Class Dogs, Regular Class Bitches, Best of Breed (Variety) (Dogs-Bitches).

### OFFICIAL NOTICE: Substitution of Judges.

Reference Chapter 7, Section 8 of AKC Rules: Owner has the right to withdraw his entry and have his entry fee refunded provided notification of his withdrawal is received no later than one half-hour prior to the start of any regular conformation judging.

Dr Andrew A Kramer is deleted from the panel. Mrs Judith Felton will judge Norfolk Sweepstakes.

### OFFICIAL NOTICE: Additional Judges.

Reference Chapter 7, Section 13 of AKC Rules: Owner has the right to withdraw his entry and have his entry fee refunded provided notification of his withdrawal is received no later than one half-hour prior to the start of any regular conformation judging.

Mr Edd Embry Bivin will judge Spaniels (Boykin) in place of Mr Robert Stein.

There are 1614 dogs entered in this show with a total of 1673 entries.

### RING 1 MRS KEKE KAHN (92)

#### 9:00 am

- 8 Basset Hounds 2-3-1-1
- 1 Brace
- 8 Australian Cattle Dogs 2-3-1-2
- 18 Weimaraners 5-10-3-0

#### 10:15 am

- 30 Doberman Pinschers 9-14-3-4

#### 11:20 am

- 2 Dachshunds (Wirehaired) 1-0-0-1
- 5 Dachshunds (Smooth) 0-4-0-1
- 15 Spaniels (English Cocker) 3-9-2-1
- 6 Dachshunds (Longhaired) 2-2-2-0

### RING 2 MRS CHARLOTTE P PATTERSON (132)

#### 9:25 am

- 24 Whippets 7-11-5-1
- MRS PATTERSON MOVES TO RING 4

### RING 2 MR MICHAEL H FAULKNER (104)

#### 10:25 am

- 17 Pembroke Welsh Corgis 5-7-3-2
- 8 Setters (Irish) 3-3-2-0
- 30 Retrievers (Labrador) 6-21-1-2

#### 1:05 pm

- 5 Setters (English) 3-2-0-0
- 15 Retrievers (Chesapeake Bay) 1-7-2-4
- 1 Brace
- 5 Setters (Gordon) 2-2-1-0
- 10 Open Senior
- 3 Open Intermediate
- 2 Open Junior
- 2 Novice Senior
- 3 Novice Intermediate
- 4 Novice Junior

### RING 3 MS JANE ROPPOLO (151)

#### 9:00 am

- 15 Mastiffs 5-7-2-1
- 28 Rottweilers 9-15-3-1

#### 10:40 am

- 6 Bullmastiffs 0-4-2-0
- 6 Greater Swiss Mountain Dogs 1-2-1-1
- 1 Brace
- 8 Newfoundland 3-3-1-1
- 10 Siberian Huskies 3-3-3-1

#### 11:55 am

#### LUNCH

#### 12:40 pm

- 1 German Pinschers 0-0-1-0
- 1 Great Pyrenees 0-0-1-0
- 1 Dogues de Bordeaux 0-1-0-0
- 3 Standard Schnauzers 0-2-1-0
- 8 Portuguese Water Dogs 1-2-5-0
- 8 Samoyeds 3-2-2-1
- 11 Giant Schnauzers 1-4-4-2

#### 2:00 pm

- 17 Borzois 6-4-5-1
- 1 Brace
- 28 Afghan Hounds 10-12-2-4

### RING 4 MRS JEAN FOURNIER (120)

#### 9:00 am

- 8 Italian Greyhounds 1-4-2-1
- MRS FOURNIER MOVES TO RING 8

### RING 4 MRS CHARLOTTE P PATTERSON

#### 10:30 am

- 16 Chihuahuas (Smooth Coat) 6-4-3-3
- 17 Chihuahuas (Long Coat) 6-7-3-1

#### 11:50 am

#### LUNCH

#### 12:35 pm

- 3 Affenpinschers 1-0-2-0

**BEXAR COUNTY KENNEL CLUB, INC.****Saturday, July 16, 2011**

- 4 Maltese 1-2-0-1
- 15 Boston Terriers 5-5-3-2
- 18 Japanese Chin 6-4-5-2
- 1 Brace

**2:10 pm**

- 34 Cavalier King Charles Spaniels 12-16-5-0
  - 1 Brace
  - 1 Manchester Terriers (Toy) 0-1-0-0
- MRS PATTERSON IS ALSO IN RING 2

**RING 5****MR VINCENT T GROSSO (155)****9:00 am**

- 36 American Staffordshire Terriers 17-14-3-2

**10:25 am**

- 3 Bull Terriers (White) 2-1-0-0
- 6 Bull Terriers (Colored) 2-1-1-2
- 5 Staffordshire Bull Terriers 2-1-2-0
- 5 Kerry Blue Terriers 1-2-2-0
- 7 Soft Coated Wheaten Terriers 2-2-1-2

**11:30 am**

- 6 Swedish Vallhunds 3-0-2-1
- 13 Scottish Terriers 2-9-2-0

**12:15 pm**

LUNCH

**1:00 pm**

- 1 Black Russian Terriers 0-0-1-0
- 1 Beaucerons 0-0-0-1
- 2 Airedale Terriers 0-0-1-1
- 7 Akitas 1-3-2-1
- 3 Fox Terriers (Wire) 0-1-2-0
- 3 Lakeland Terriers 1-2-0-0
- 8 Border Terriers 1-4-0-3

**2:00 pm**

- 1 Skye Terriers 0-0-1-0
- 1 Parson Russell Terriers 0-0-1-0
- 1 Bedlington Terriers 0-0-0-1
- 3 Sealyham Terriers 0-0-1-1
- 1 Brace
- 4 Welsh Terriers 3-1-0-0
- 5 West Highland White Terriers 1-2-1-1
- 2 Manchester Terriers (Standard) 1-0-1-0
- 4 Fox Terriers (Smooth) 1-0-3-0
- 28 Miniature Schnauzers 9-14-5-0

**RING 6****MRS KATHLEEN M GROSSO (169)****9:00 am**

- 6 Toy Fox Terriers 1-2-3-0
- 19 French Bulldogs 5-7-6-1

**10:00 am**

- 19 Silky Terriers 8-3-4-4
- 24 Poodles (Miniature) 6-13-4-1

**11:40 am**

- 11 Shih Tzu 2-7-2-0

**12:10 pm**

LUNCH

**12:55 pm**

- 21 Poodles (Standard) 5-10-2-4
- 47 Yorkshire Terriers 13-21-10-3

**3:40 pm**

- 22 Poodles (Toy) 10-10-0-2

**RING 7****MR JON R COLE (144)****9:00 am**

- 13 Pugs 4-2-3-3
- 1 Brace
- 17 Miniature Pinschers 8-6-2-1

**RING 7****MRS JUDITH FELTON (2)****10:10 am**

- 2 Norfolk Terriers Sweepstakes Entries

**RING 7****MR JON R COLE****10:20 am**

- 20 Norfolk Terriers 2-6-2-9
- 1 Veteran Bitch
- 13 Havanese 1-10-2-0

**11:40 am**

- 1 Australian Terriers 0-0-1-0
  - 3 Pekingese 0-1-2-0
  - 6 Cairn Terriers 0-3-1-2
- MR COLE GOES TO LUNCH  
MR COLE MOVES TO RING 9

**RING 7****MS MAGDA OMANSKY (19)****12:05 pm**

- 19 Norwich Terriers Sweepstakes Entries

**RING 7****MR EDD EMBRY BIVIN (137)****12:50 pm**

- 48 Norwich Terriers 14-17-11-3
- 1 Veteran Bitch
- 1 Stud Dog
- 1 Brood Bitch

**2:45 pm**

- 4 Bichons Frises 1-2-1-0
  - 2 Xoloitzcuintli 0-2-0-0
  - 8 Norwegian Lundehunds 3-4-1-0
  - 3 Spaniels (Boykin) 0-2-1-0
- MR BIVIN IS ALSO IN RING 9

**RING 8****MRS JEAN FOURNIER****9:25 am**

- 12 Cardigan Welsh Corgis 5-5-0-2
- 7 Anatolian Shepherd Dogs 1-3-2-0
- 1 Brace
- 12 Border Collies 4-2-5-1

**10:40 am**

- 5 Belgian Tervuren 1-2-2-0
- 5 Old English Sheepdogs 1-0-2-2
- 11 Bouviers des Flandres 2-4-3-2
- 11 Belgian Sheepdogs 1-4-5-1

**11:55 am**

LUNCH

# BEXAR COUNTY KENNEL CLUB, INC.

Saturday, July 16, 2011

## 12:40 pm

- 1 English Toy Spaniels (B & P C) 0-0-1-0
  - 2 Pulik 1-0-1-0
  - 3 English Toy Spaniels (K C & R) 0-2-1-0
  - 2 Collies (Rough) 0-0-1-1
  - 2 Alaskan Malamutes 0-0-1-1
  - 1 Bernese Mountain Dogs 0-0-1-0
  - 1 Belgian Malinois 0-0-0-1
  - 3 Briards 0-2-1-0
  - 2 Collies (Smooth) 0-1-1-0
  - 32 Australian Shepherds 12-15-4-1
- MRS FOURNIER IS ALSO IN RING 4

### RING 9

MR EDD EMBRY BIVIN

## 9:00 am

- 45 Great Danes 19-18-7-1

## 10:50 am

- 5 Cane Corso 3-0-1-1
  - 22 Boxers 6-12-1-3
- MR BIVIN GOES TO LUNCH  
MR BIVIN MOVES TO RING 7

### RING 9

MR JON R COLE

## 12:50 pm

- 3 Icelandic Sheepdogs 1-2-0-0
- 24 German Shepherd Dogs 7-12-2-3

## 1:55 pm

- 4 Bearded Collies 0-1-1-2
  - 8 Keeshonden 1-4-3-0
  - 7 American Eskimo Dogs 1-4-0-2
  - 25 Shetland Sheepdogs 11-12-1-1
- MR COLE IS ALSO IN RING 7

### RING 10

MR ROBERT STEIN (175)

## 9:00 am

- 4 Chinese Shar-Pei 1-1-0-2
- 25 Bulldogs 10-12-1-2
- 11 Chow Chows 3-4-2-1
- 1 Brace

## 10:20 am

- 4 Spaniels (Clumber) 1-1-2-0
- 7 Dalmatians 1-3-0-3
- 24 Vizslas 7-9-4-4

## 11:30 am

- 8 Brussels Griffons 3-3-0-2
- 13 Spaniels (Cocker) Ascob 1-11-1-0

## 12:15 pm

LUNCH

## 1:00 pm

- 2 Spaniels (Cocker) Parti-Color 0-1-0-1
- 2 Beagles (15 Inch) 0-1-1-0
- 4 Lhasa Apsos 1-0-3-0
- 9 Petits Bassets Griffons Vendeens 2-2-3-2

- 10 Tibetan Spaniels 4-2-2-2

- 10 Spaniels (Cocker) Black 2-7-1-0

## 2:15 pm

- 1 Pharaoh Hounds 0-0-1-0
- 1 American Foxhounds 0-0-1-0
- 1 Harriers 0-0-1-0
- 4 Salukis 1-0-2-1
- 3 Otterhounds 1-0-1-0
- 1 Brace
- 3 Ibizan Hounds 1-1-1-0
- 4 Retrievers (Nova Scotia Duck Tolling) 0-2-2-0
- 9 Finnish Lapphunds 2-7-0-0
- 16 Rhodesian Ridgebacks 5-6-3-2

### RING 11

MRS SUSAN ST JOHN-BROWN (145)

## 9:00 am

- 32 Pointers (German Shorthaired) 6-14-10-2

## 10:15 am

- 3 Retrievers (Flat-Coated) 0-2-1-0
- 4 Greyhounds 0-2-2-0
- 11 Pointers 7-1-2-1
- 13 Basenjis 3-8-1-1

## 11:30 am

- 2 Shiba Inu 0-0-1-1
- 3 Tibetan Terriers 1-1-0-1
- 12 Schipperkes 0-9-2-1

## 12:10 pm

LUNCH

## 12:55 pm

- 1 Dogo Argentine (Misc. Bitch)
- 1 Pointers (German Wirehaired) 0-0-1-0
- 63 Retrievers (Golden) 23-29-8-2
- 1 Brace

### RING 12

MISS MAXINE V BEAM (128)

## 9:00 am

- 31 Papillons 10-17-1-3

## 10:15 am

- 25 Chinese Cresteds 12-8-3-2

## 11:15 am

- 26 Spaniels (English Springer) 8-11-4-3

## 12:15 pm

LUNCH

## 1:00 pm

- 16 Pomeranians 7-5-3-1
- 30 Brittany 12-11-5-2

### GROUP RING

## 3:30 pm

VARIETY GROUP JUDGING

Order will be announced by 3:00 pm

**COMAL COUNTY KENNEL CLUB, INC.****Sunday, July 17, 2011****JUDGING PROGRAM**

The number before each Breed (Variety) indicates the number of dogs entered in that Breed (Variety). The numbers following each Breed (Variety) indicates the number of Regular Class Dogs, Regular Class Bitches, Best of Breed (Variety) (Dogs-Bitches).

There are 1559 dogs entered in this show with a total of 1571 entries.

**RING 1****MRS MARILYN Y PIPES (31)****8:30 am**

- 11 Pointers 7-1-2-1
- 5 Setters (Gordon) 2-2-1-0
- 15 Spaniels (English Cocker) 3-9-2-1

**RING 1****MR MICHAEL H FAULKNER (107)****9:45 am**

- 9 Pugs 3-2-1-3
- 17 Silky Terriers 6-4-3-4
- 4 Retrievers (Nova Scotia Duck Tolling) 0-2-2-0

**10:45 am**

- 4 Spaniels (Clumber) 1-1-2-0
- 2 Collies (Rough) 0-0-1-1
- 3 Spaniels (Boykin) 0-2-1-0
- 3 Briards 0-2-1-0
- 5 Old English Sheepdogs 1-0-3-1
- 2 Collies (Smooth) 0-1-1-0
- 58 Retrievers (Golden) 22-27-8-1

**RING 2****MR VINCENT T GROSSO (118)****8:30 am**

- 16 Pembroke Welsh Corgis 5-6-4-1
- 23 German Shepherd Dogs 6-12-2-3

**10:05 am**

- 30 Australian Shepherds 11-14-4-1

**11:15 am**

- 5 Cane Corso 3-0-1-1
  - 5 Belgian Tervuren 1-2-2-0
  - 11 Border Collies 4-1-5-1
- MR GROSSO GOES TO LUNCH

**RING 2****MRS SUSAN L CLEMONS (8)****12:05 pm**

- 8 Setters (Irish) 3-2-2-1

**RING 2****MR VINCENT T GROSSO****12:50 pm**

- 1 Dogo Argentine (Misc. Bitch)
- 1 Peruvian Inca Orchids (Misc. Dog)
- 2 Peruvian Inca Orchids (Misc. Bitches)
- 1 Belgian Malinois 0-0-0-1
- 4 Bearded Collies 0-1-1-2
- 9 Australian Cattle Dogs 2-4-1-2
- 10 Belgian Sheepdogs 1-4-4-1

**RING 3****MR JON R COLE (173)****8:30 am**

- 43 Great Danes 19-16-7-1

**10:10 am**

- 10 Chow Chows 3-4-2-1
- 16 Mastiffs 5-8-2-1

**11:15 am**

- 1 Great Pyrenees 0-0-1-0
  - 1 Beaucerons 0-0-0-1
  - 22 Poodles (Miniature) 5-13-3-1
- MR COLE GOES TO LUNCH  
MR COLE MOVES TO RING 6

**RING 3****MRS JEAN FOURNIER (158)****12:50 pm**

- 28 Shetland Sheepdogs 12-14-1-1

**1:55 pm**

- 1 German Pinschers 0-0-1-0
  - 2 Dogues de Bordeaux 1-1-0-0
  - 5 Greater Swiss Mountain Dogs 1-2-1-1
  - 10 Finnish Lapphunds 3-7-0-0
  - 28 Retrievers (Labrador) 5-20-1-2
- MRS FOURNIER IS ALSO IN RING 6

**RING 4****MRS KATHLEEN M GROSSO (131)****8:30 am**

- 7 Dalmatians 1-3-0-3
- 32 American Staffordshire Terriers 16-11-3-2

**10:05 am**

- 15 Boston Terriers 5-5-3-2
- 30 Papillons 9-18-1-2

**11:50 am**

LUNCH

**12:35 pm**

- 2 Airedale Terriers 0-0-1-1
- 3 Shiba Inu 0-0-2-1
- 3 Tibetan Terriers 1-1-0-1
- 6 Cairn Terriers 0-3-1-2
- 9 Tibetan Spaniels 3-2-2-2
- 12 Pomeranians 6-2-3-1
- 12 Schipperkes 0-9-2-1

**RING 5****MRS CHARLOTTE P PATTERSON (122)****8:30 am**

- 5 Staffordshire Bull Terriers 2-1-2-0
- 24 Bulldogs 10-11-1-2

**9:40 am**

- 4 Chinese Shar-Pei 1-1-0-2

# COMAL COUNTY KENNEL CLUB, INC.

Sunday, July 17, 2011

- 7 Soft Coated Wheaten Terriers 2-2-1-2
- 5 Kerry Blue Terriers 1-2-2-0
- 3 Bull Terriers (White) 2-1-0-0
- 6 Bull Terriers (Colored) 2-1-1-2

## 10:40 am

- 4 Fox Terriers (Smooth) 1-0-3-0
- 3 Lakeland Terriers 1-2-0-0
- 4 West Highland White Terriers 0-2-1-1
- 8 Border Terriers 1-4-0-3
- 13 Scottish Terriers 2-9-2-0

## 11:55 am

LUNCH

## 12:40 pm

- 1 Bedlington Terriers 0-0-0-1
- 1 Australian Terriers 0-0-1-0
- 2 Welsh Terriers 1-1-0-0
- 3 Fox Terriers (Wire) 0-1-2-0
- 2 Manchester Terriers (Standard) 1-0-1-0
- 27 Miniature Schnauzers 8-14-5-0

### RING 6 MRS JEAN FOURNIER

## 8:30 am

- 10 Open Senior
- 3 Open Intermediate
- 1 Open Junior
- 1 Novice Senior
- 2 Novice Intermediate
- 4 Novice Junior

## 9:30 am

- 6 Toy Fox Terriers 1-2-3-0
- 8 Brussels Griffons 3-3-0-2
- 30 Yorkshire Terriers 7-13-8-2

## 11:20 am

- 1 Manchester Terriers (Toy) 0-1-0-0
- 3 Pekingese 0-1-2-0
- 4 Maltese 1-2-0-1
- 11 Shih Tzu 2-7-2-0

MRS FOURNIER GOES TO LUNCH

MRS FOURNIER MOVES TO RING 3

### RING 6 MR JON R COLE

## 12:55 pm

- 4 Affenpinschers 2-0-2-0
- 21 Poodles (Toy) 10-9-0-2

## 1:55 pm

- 2 Pulik 1-0-1-0
- 19 Chihuahuas (Smooth Coat) 7-7-3-2
- 13 Chihuahuas (Long Coat) 5-5-2-1

## 3:15 pm

- 21 Poodles (Standard) 5-10-2-4

MR COLE IS ALSO IN RING 3

### RING 7 MR ROBERT STEIN (132)

## 8:30 am

- 8 Italian Greyhounds 1-4-2-1
- 14 Miniature Pinschers 6-6-1-1
- 12 Japanese Chin 5-2-5-0

## 9:40 am

- 2 Xoloitzcuintli 0-2-0-0
- 3 English Toy Spaniels (K C & R) 0-2-1-0
- 11 Havanese 0-9-2-0
- 8 Norwegian Lundehunds 3-4-1-0

MR STEIN MOVES TO RING 8

### RING 7 MR EDD EMBRY BIVIN (125)

## 11:00 am

- 1 Pointers (German Wirehaired) 0-0-1-0
- 1 Bernese Mountain Dogs 0-0-1-0
- 1 Black Russian Terriers 0-0-1-0
- 2 Alaskan Malamutes 0-0-1-1
- 3 Retrievers (Flat-Coated) 0-2-1-0
- 22 Chinese Cresteds 10-7-3-2

## 12:10 pm

LUNCH

## 12:55 pm

- 33 Cavalier King Charles Spaniels 10-18-5-0

MR BIVIN IS ALSO IN RING 8

### RING 8 MR EDD EMBRY BIVIN

## 8:30 am

- 30 Pointers (German Shorthaired) 7-13-9-1

## 9:40 am

- 6 Bullmastiffs 0-3-3-0
- 6 Anatolian Shepherd Dogs 1-3-2-0
- 10 Retrievers (Chesapeake Bay) 0-4-2-4
- 10 Giant Schnauzers 1-4-4-1

MR BIVIN MOVES TO RING 7

### RING 8 MR ROBERT STEIN

## 11:00 am

- 28 Rottweilers 10-14-3-1

MR STEIN GOES TO LUNCH

### RING 8 DANIEL G SENA DDS (47)

## 12:00 pm

- 2 Spaniels (Cocker) Parti-Color 0-1-0-1
- 13 Spaniels (Cocker) Ascob 1-11-1-0

### RING 8 MR ROBERT STEIN

## 12:45 pm

- 3 Standard Schnauzers 0-2-1-0
- 8 Samoyeds 3-2-2-1
- 8 Portuguese Water Dogs 1-2-5-0
- 7 Akitas 1-3-2-1
- 8 Newfoundlands 3-3-1-1
- 12 Siberian Huskies 5-3-3-1

MR STEIN IS ALSO IN RING 7

**COMAL COUNTY KENNEL CLUB, INC.**  
**Sunday, July 17, 2011**

**RING 8**  
**DANIEL G SENA DDS**

**2:20 pm**

- 10 Spaniels (Cocker) Black 2-7-1-0
- 22 Spaniels (English Springer) 7-9-4-2

**RING 9**  
**MRS SUSAN ST JOHN-BROWN (153)**

**8:30 am**

- 26 Vizslas 7-10-5-4

**9:30 am**

- 21 Weimaraners 7-11-3-0
- 19 French Bulldogs 5-7-6-1

**11:10 am**

- 23 Whippets 7-10-5-1

**12:05 pm**

LUNCH

**12:50 pm**

- 29 Afghan Hounds 10-12-3-4

**2:00 pm**

- 2 Dachshunds (Wirehaired) 1-0-0-1
- 4 Lhasa Apsos 1-0-3-0
- 5 Dachshunds (Longhaired) 1-2-2-0
- 5 Bichons Frises 1-3-1-0
- 5 Dachshunds (Smooth) 0-4-0-1
- 7 American Eskimo Dogs 1-4-0-2
- 7 Keeshonden 1-4-2-0

**RING 10**  
**MS JANE ROPPOLO (127)**

**8:30 am**

- 7 Basset Hounds 2-3-1-1
- 26 Boxers 7-15-1-3

**9:50 am**

- 30 Doberman Pinschers 9-14-3-4

**11:00 am**

- 5 Setters (English) 2-3-0-0
- 9 Petits Bassets Griffons Vendeens 2-2-3-2
- 13 Basenjis 3-8-1-1

**12:05 pm**

LUNCH

**12:50 pm**

- 2 Beagles (15 Inch) 0-1-1-0
- 1 Pharaoh Hounds 0-0-1-0
- 1 Otterhounds 0-0-1-0
- 1 Norwegian Elkhounds 1-0-0-0
- 32 Brittany's 13-11-5-3

**RING 11**  
**MRS KEKE KAHN (139)**

**8:30 am**

- 6 Greyhounds 0-3-2-1
- 16 Rhodesian Ridgebacks 5-7-3-1
- 42 Norwich Terriers 12-16-11-3

**10:50 am**

- 6 Swedish Vallhunds 3-0-2-1
- 12 Cardigan Welsh Corgis 5-5-0-2
- 19 Norfolk Terriers 2-6-2-9

**12:15 pm**

LUNCH

**1:00 pm**

- 1 Parson Russell Terriers 0-0-1-0
- 1 Skye Terriers 0-0-1-0
- 3 Ibizan Hounds 1-1-1-0
- 3 Icelandic Sheepdogs 1-2-0-0
- 4 Salukis 1-0-2-1
- 11 Bouviers des Flandres 2-4-3-2
- 13 Borzois 5-3-5-0
- 1 American Foxhounds 0-0-1-0
- 1 Harriers 0-0-1-0

**GROUP RING**

**2:30 pm**

VARIETY GROUP JUDGING

Order will be announced by 2:00 pm

**DOG SHOW TOURS**  
will be conducted on  
**Saturday, July 16 & Sunday, July 17, 2011**

**Hosted by**

Alamo Area Toy Dog Club, Inc.  
Bexar County Kennel Club, Inc.  
Comal County Kennel Club, Inc.

## IMPORTANT MOTEL INFORMATION

**Most of the motels listed will accept dogs; however, it is up to the exhibitors to respect their property. Unless dog exhibitors observe their responsibilities, they may find themselves unable to use any public lodging. Occupants of the room will be held liable for damages. Most properties will require a non-refundable pet deposit; inquire when making your reservation.**

**The motels listed expect you to observe the following rules:**

- 1 Do not let your dogs destroy or foul the rooms.
- 2 Use only the designated exercise areas.
- 3 All unattended dogs must be left crated. Some properties will not clean rooms if you do not adhere to this rule.
- 4 All dogs should be kept on a short, tight lead when walking in halls & through the lobby. Keep dogs away from walls, posts & lobby furniture.

**All area codes will be 210 except where noted.**

Clarion Hotel/Motel -- 3855 I-35 S, Exit 162 .....	226-4361
Comfort Suites - 6350 I-35N, Exit 164 A .....	646-6000
Days Inn - 3443 I-35 S, Exit 160 .....	225-4040
Days Inn -- 9401 I-35, Exit 167 A .....	650-9779
Days Inn -11202 I-35 S, Exit 168 .....	655-4312
Hampton Inn & Suites, 6718 I-35 N, Exit 164 A .....	599-4800
Hawthorn Suites - 6900 I-35 N, Exit 164 A .....	798-3900
Howard Johnson -- 3817 I-35 S, Exit 162 .....	224-3030
La Quinta Inn - 6410 I-35 N, Exit 164 A .....	653-6619
Microtel Inn - 3911 I-35 S, Exit 162 .....	1-800-466-8827
Super 8 - 3617 N Pan Am Expressway, Exit 160 .....	227-8888
Travelodge Inn - 3821 I-35 N, Exit 162 .....	224-5114
Travelodge - 3939 E. Houston St - I-10 E, Exit 579 .....	359-1111
Red Roof - 4403 E. I-10, Exit 580 .....	333-9430
Alamo KOA Kampgrounds - 602 Gemblar (Off AT & T Pkw) .....	224-9296

## HANDICAP PARKING

Handicap parking is available on the regular parking lot.

## ATTENTION EXHIBITORS

### GENERAL

The show site will be available to exhibitors Tuesday, July 12th from 6 pm until 10 pm and from 6 am until 11 pm Wednesday through Saturday, July 16th. On Sunday from 6:00 am until 2 hours after BIS. **You must be out of the building by 11:00 pm each night.**

**THE BUILDING WILL BE LOCKED BETWEEN THE HOURS OF 11 PM AND 6 AM DAILY.**

**EMERGENCY PHONE NUMBER: (210) 859-7677**

**THIS IS A NON-SMOKING FACILITY. SMOKING WILL ONLY BE ALLOWED OUTSIDE THE BUILDING.**

**SECURITY WILL NOT ALLOW ANYONE TO SLEEP OVERNIGHT IN THE BUILDING.**

**VICIOUS DOG ORDINANCE: PLEASE BE AWARE THAT THE SAN ANTONIO CITY COUNCIL HAS APPROVED A VICIOUS DOG ORDINANCE WHICH CAN INCLUDE FINES, IMPOUNDMENT AND/OR NEUTERING FOR ANY DOG WHICH BITES A PERSON OR ANOTHER DOG.**

**A LARGE GRASS EXERCISE AREA WILL BE LOCATED ON THE EAST SIDE OF THE BUILDING.**

Puppies under the age of 6 months are strictly prohibited from entry into the building.

The welfare of an exhibitor's child is assumed to be the responsibility of the exhibitor. It is distinctly understood that exhibitors will exercise **CONTROL** and **RESTRAINT** over their children while attending these shows.

The Show Committees from the participating clubs assume no responsibility for fire, theft and/or loss or damage to any animal, equipment, or personal items brought into the building.

**Bathing facilities for your dogs will be located outside on the East side of the building. Tubs will be removed at 4:00 pm on Sunday.**

**ALL PRIZES MUST BE CLAIMED THE DAY OF THE SHOW. NO PRIZES WILL BE MAILED.**

### UNLOADING AND LOADING

All grooming and crating will be Halls A & B. You may drive in starting at 6 pm on Tues until 10 pm. On Wednesday, drive in will begin at 6 am until 9 pm or until the security officer on duty deems it unsafe. **Drive in will not be allowed** from 9 pm on Wednesday until after BIS on Sunday. All crates and grooming equipment must be removed from the building 2 hours after BIS on Sunday.

### RESERVED GROOMING SPACE

**NO NEED TO RUSH DOWN AND WAIT IN LINE TUESDAY FOR A PLACE TO SET-UP. YOU CAN RESERVE YOUR SPACE IN ADVANCE AND HAVE IT WAITING FOR YOU.**

**RESERVED GROOMING IS LOCATED IN THE HALLS A & B.**

**THERE ARE SEVERAL SIZES TO CHOOSE FROM:**

10 ft x 10 ft, \$25.00	15 ft x 20 ft \$80.00
10 ft x 15 ft, \$40.00	20 ft x 20 ft \$100.00
10 ft x 20 ft \$50.00	20 ft x 30 ft \$150.00

**ALL RULES APPLYING TO REGULAR GROOMING AREA WILL APPLY TO RESERVE GROOMING AREA.**

**ALL REQUESTS WILL BE HANDLED ON A FIRST COME BASIS. DEADLINE WILL BE THE CLOSE OF ENTRIES, JUNE 29th OR WHEN ALL ALLOTTED SPACE IS SOLD. SEE RESERVE GROOMING RULES AND SPACE REQUEST FORM LOCATED IN THIS PREMIUM LIST.**

### REGULAR GROOMING AND CRATING

All regular grooming and crating will also be in Hall A. All crating space is provided on first come, first serve basis. **ROPING OFF OR SAVING UNUSED CRATING SPACE BY ANY MEANS IS STRICTLY PROHIBITED. ALL CRATES MUST BE STACKED. EACH EXHIBITOR IS RESPONSIBLE FOR CLEAN CONDITIONS IN AND AROUND HIS OR HER SET UP. REMEMBER TO BRING A BROOM.**

#### **RING SIDE HOLDING AREA**

**A HOLDING AREA WILL BE MARKED OFF IN HALL C BETWEEN THE RINGS. ONLY CRATES AND TOY TABLES WILL BE ALLOWED IN THIS AREA. PLEASE STACK YOUR CRATES; MULTIPLE CRATES ON A DOLLY WILL BE ALLOWED. PLEASE REMOVE YOUR CRATES AND TABLES AT THE CONCLUSION OF YOUR BREED JUDGING.**

#### **DAY CRATING**

**A SPACE WILL BE PROVIDED IN HALL B FOR THOSE WHO "SHOW AND GO". THIS SPACE WILL BE AVAILABLE FROM THURSDAY THROUGH SUNDAY. ONLY CRATES AND GROOMING TABLES WILL BE ALLOWED IN THIS AREA. NO EXERCISE OR DROP PENS WILL BE ALLOWED. EVERYTHING MUST BE REMOVED EACH NIGHT AND THIS AREA LEFT EMPTY. ANYTHING LEFT IN THIS AREA WILL BE PICKED UP BY THE SHOW COMMITTEE. ALL RULES APPLYING TO GROOMING AND CRATING WILL APPLY TO THIS SECTION.**

#### **EXERCISE PENS AND AREAS**

**PUBLIC EXERCISE AREAS WILL BE PROVIDED IN HALLS A & B AND ON THE EAST SIDE OF THE BUILDING NEAR THE GRASS PAD. THE SHOW COMMITTEE RESERVES THE RIGHT TO LIMIT THE NUMBER AND SIZE OF EXERCISE PENS.**

**In an effort to control odors inside the building, it is required the exhibitors remove all SOILED material from crates, exercise pens and under drop pens each night before leaving the show site and replace with clean, fresh material. Wood shaving will be furnished. NO MATS, CARPETS OR SOD WILL BE ALLOWED INSIDE THE BUILDING. PLEASE DO NOT PUT PLASTIC UNDER EXERCISE PENS, CRATES OR TABLES. The Pig Patrol will check the grooming and crating area each night and those exhibitors not complying with these rules will be noted. Continuous violators will be asked to leave the building. Exhibitors are asked to help us keep the grooming and crating area clean and free of odors.**